

DS-UNIT SYSTEM FOR INBOARD APPLICATION



TWO STATION
TWIN ENGINE

ISSUE DATE NOV-2010
DATA SHEET NO INT-MC(DA)1

DS-Unit Gear 207573

TWO STATION TWIN ENGINE KIT	NO OF UNITS	PART NO
DS-Unit Gear	2	207573
Station selector unit	1	204993
DS-Unit Throttle	2	177030

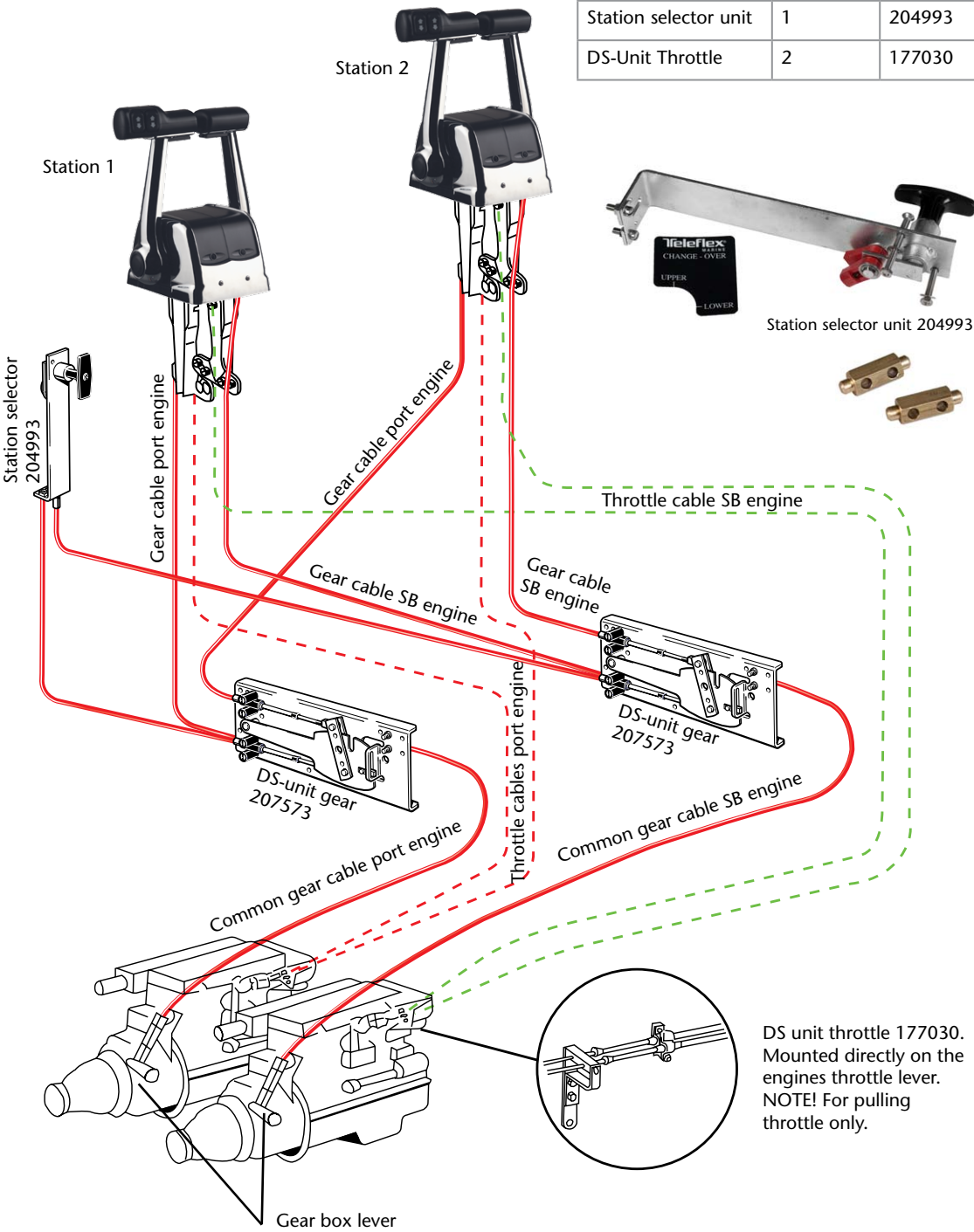

TWO STATION SINGLE ENGINE

TWO STATION SINGLE ENGINE KIT	NO OF UNITS	PART NO
DS-Unit Gear	1	207573
Station selector unit	1	204993
DS-Unit Throttle	1	207572

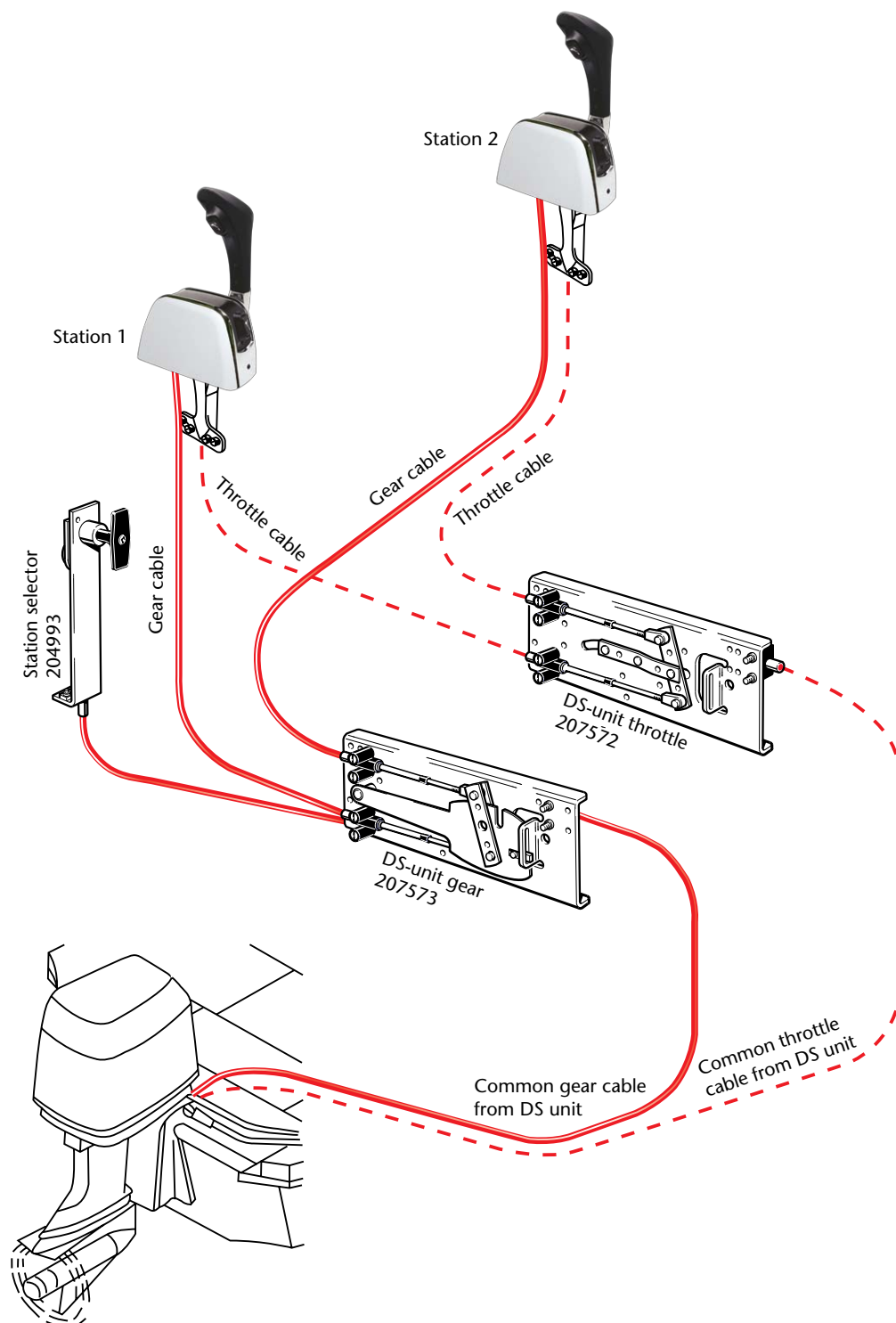

TWO STATION SINGLE ENGINE

TWO STATION SINGLE ENGINE KIT	NO OF UNITS	PART NO
DS-Unit Gear	1	207573
Station Selector Unit	1	204993
DS-Unit Throttle	1	177030

